



LED STRIP FOR LED HANDRAIL

LED strip H12W16 to integrate into LED stair railing tubes or handrails. Professional light fitting easily into round body guards. The LED handrail is used to highlight walkways or stairs.

APPLICATION

- Architectural lighting
- Interior Lighting
- Outdoor lighting

LED STRIP FOR LED HANDRAIL

Technical data	H12W16 – 12W	H12W16 – 8W
Dimensions	Section 12*16mm - Length 3m max.	
Number of LEDs	60LED/m	120LED/m
Power	12W	8W
Body materials	Anodised aluminium profile with clear or diffusing PC cover. Anti-UV PU resin.	
Colour	White	
Color temperature (white)	2700K 3000K 4000K 5000K	
IRC	80	
Luminous flux	1000lm/m	
Gradable	Yes	
Angle	120°	
Lifespan	50 000 hours L 70	
operating temperature	-20°C to +50°C	
Voltage	24Vcc	
Electrical class	Class III	
Connection	Cable HO5 RNF 2/4 wires*0,75mm ² 1 meter long	
IK	IK10	
IP	IP67	
Fixation	By stainless steel or composite clips	
Glow wire test	850°C	
Warranty	3 years	

Photometric data +/- 10%, the manufacturer reserves the right to modify the characteristics without prior notice.

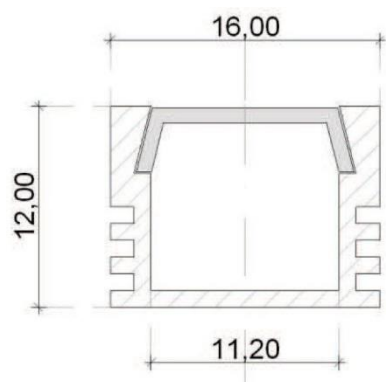

Eccelectro
 LED innovation

04 78 56 62 62
info@eccelectro.com
www.eccelectro.com